

Silent Check Valve

FIG. 5106

Specifications

- Complies with requirements of EN 16767.
- The design is for liquid service and offers many obvious advantages when compared with conventional swing check valve.
- Spring automatically closes disc at zero flow before flow reversal occurs. This prevents surge and water hammer.
- Completely guided disc both top and bottom.
- Perfect tightness soft sealed even at low differential pressure.
- Flanged and drilling comply with EN1092-2 PN10/16, ANSI B 16.1 Class125.
- Rated Working Pressure 16 bar.
- WRAS Approved: DN50-DN300, CI body, EPDM Seated for potable water.

Corrosion Protection

- Fusion Bonded Coating Interior and Exterior.

Material Specifications

Part	Material	EN Specification
Body	Gray Cast Iron	EN 1561 EN-GJL-250
Seat	CI Integral	EN 1561 EN-GJL-250
Disc	Gray Cast Iron	EN 1561 EN-GJL-250
Disc Ring	Rubber	EN 681 EPDM/NBR
Spring	Stainless Steel	EN 10088 X5CrNi18-10
Bushing	Bronze	EN 1982 CuSn5Zn5Pb5
Stem	Stainless Steel	EN 10088 X20Cr13
	Brass	EN 12164 CuZn39Pb1
Bracket	Gray Cast Iron	EN 1561 EN-GJL-250

- Valve Bodies of 25 bar / 300 psi, DN350 and larger sizes are Ductile Iron.

Options

- 25 bar /300 psi available.
- Ductile Iron Body.

Main Dimensions (mm)

Size	DN50	DN65	DN80	DN100	DN125	DN150	DN200	DN250	DN300	DN350	DN400
L	100	120	140	170	200	230	288	354	410	460	500

Schematic

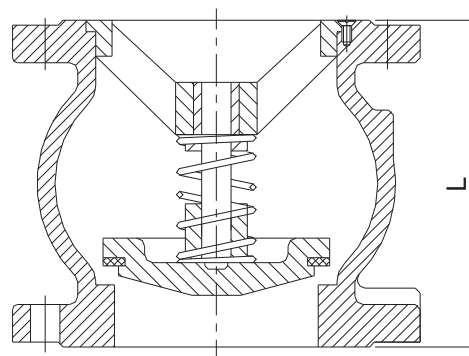
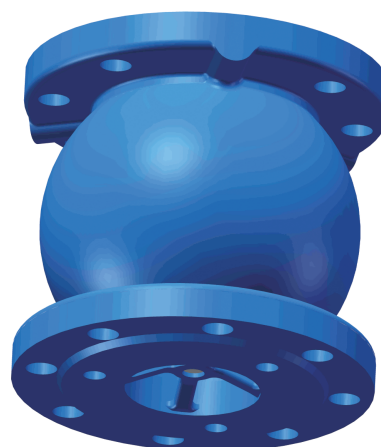

Notes

- Designs, materials and specifications shown are subject to change without notice due to the continuous development of our products.