

Eccentric Plug Valve FL x FL Ends & MJ x MJ Ends

FIG. 1105
FIG. 1605

Specifications

- Seat area with welded overlay minimum 95% pure nickel.
- Shaft sealed by the multiple V-ring type.
- Round plug fully rubber coated up to 12", plugs 14" to 24" have a cylindrical rubber sealed surface.
- Two test points located on each valve.
- Flanged and Drilling complies with EN1092-2 PN10/16, ANSI B16.1 Class125.
- Mechanical joint complies with AWWA/ANSI C153.
- Rated Working Pressure 16 bar / 250 psi.
- NSF/ANSI/CAN 61 & 372 Certified.

Material Specification

Part	Material	ASTM Specification
Body	Ductile Iron	A536 Grade 65-45-12
Plug	EPDM Encapsulated Ductile Iron	
Bonnet	Ductile Iron	A536 Grade 65-45-12
Shaft Bushing	Stainless Steel	A276 Type 316
Thrust Washer	PTFE	
Gasket	Rubber	D2000 NBR
V-Packing	Rubber	D2000 NBR
Packing Gland	Carbon Steel	A29 1045

- Other material types are available upon request.

Options

- 10 bar / 25 bar / 150 psi / 300 psi available.
- With Ductile Iron Gearbox Shelf.

FIG.1105 Main Dimensions (mm/inch)

Size	2"	2.5"	3"	4"	5"
L	178/7.0	190.5/7.5	203.2/8.0	229/9.0	254/10.0
H	166/6.5	172/6.8	182/7.2	200/7.9	219/8.6

Size	6"	8"	10"	12"	14"
L	267/10.5	292/11.5	330/13.0	356/14.0	432/17.0
H	274/10.8	332/13.1	433/17.4	471/18.5	536/21.1

Size	16"	18"	20"	24"	—
L	451/17.8	546/21.5	597/23.5	1067/42.0	—
H	578/22.8	609/24.0	719/28.3	727/28.6	—

FIG.1605 Main Dimensions (mm/inch)

Size	3"	4"	6"	8"	10"	12"	14"	16"	18"	20"	24"
L	292/11.5	362/14.3	400/15.7	441.5/17.4	492/19.4	527/20.7	622/24.5	692/27.2	743/29.3	787/31.0	1067/42.0
H	182/7.2	200/7.9	274/10.8	332/13.1	433/17.4	471/18.5	536/21.1	578/22.8	609/24.0	719/28.3	727/28.6

Notes

- Designs, materials and specifications shown are subject to change without notice due to the continuous development of our products.

Corrosion Protection

- Fusion Bonded Coating Interior and Exterior.

Schematic

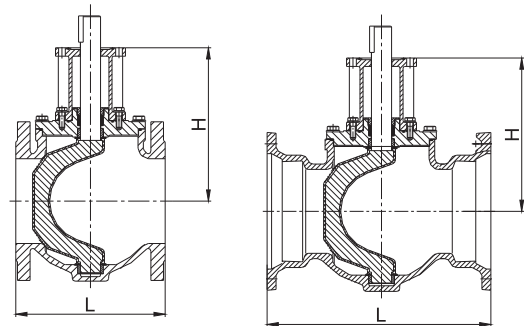

FIG. 1105, FLxFL Size 2" to 12"
FIG. 1605, MJxMJ Size 3" to 12"

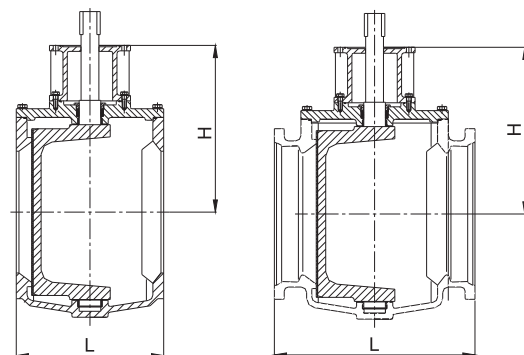

FIG. 1105, FLxFL Size 14" to 24"
FIG. 1605, MJxMJ Size 14" to 24"