

## AWWA C504/C516 Double Eccentric Butterfly Valve

FIG. 2108

### Specification

- Meet or exceed the requirements of AWWA C504 / C516.
- Double Eccentric Type.
- Robust Design.
- Rubber Seat Ring Clamped on the Disc.
- Stainless Steel Seat welded on the Body.
- Mounting Flange in accordance with ISO 5211.
- Flange and Drilling complies with ASME B16.1 Class 125 /Class 250.
- Operated with Gear Operator.
- Working Pressure 150 psi.
- Certificated to ANSI / NSF 61 & 372.

### Corrosion Protection

- Fusion Bonded Coating or Liquid Painting Interior and Exterior complies with AWWA C550.

### Material Specifications

Part	Material	ASTM Specification
Body	Ductile Iron	A536 Grade 65-45-12
Body Seat	Stainless Steel	A276 Type 304
Shaft	Stainless Steel	A276 Type 304
Disc	Ductile Iron	A536 Grade 65-45-12
Disc Seat Ring	Rubber EPDM	D2000
Disc Holding Plate	Stainless Steel	A276 Type 304
Shaft Bushing	Bronze	B148 C95200
Adjust Spacer	Bronze	B148 C95200
Shaft Sealing	O-Ring	D2000 BUNA-N
Shaft Retainer	Stainless Steel	A276 Type 304
Bottom Plate	Carbon Steel	A36

### Options

- NSF Approved Fusion Bonded Coating or Liquid Painting.
- BUNA-N Bonded Body Seat.
- 250 psi available.

### Schematic

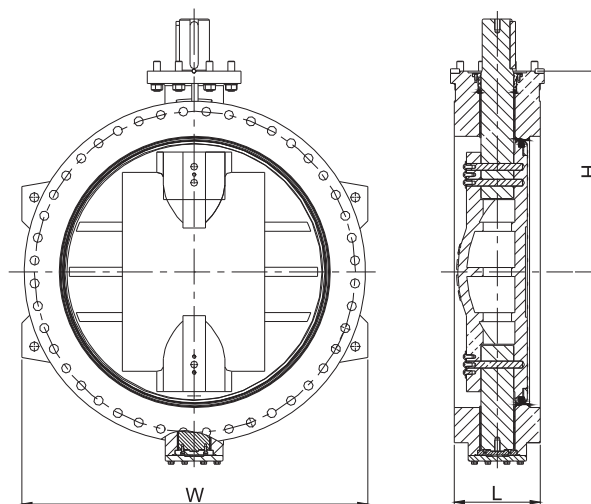

### Main Dimensions (inch/mm)

Size	30"	36"	42"	48"	54"	60"	66"	72"	78"	84"	90"	96"
L	12 (305)			15 (381)			18 (457)			24 (610)		
H	24.4 (620)	28.7 (730)	32.3 (820)	35 (890)	39.2 (995)	42.9 (1090)	49.2 (1250)	52.4 (1330)	52.4 (1330)	57.7 (1465)	60.6 (1540)	66.3 (1685)
W	40 (1020)	48 (1220)	55 (1400)	61 (1550)	67 (1700)	74 (1880)	81 (2060)	88 (2235)	94 (2390)	101 (2565)	108 (2745)	115 (2920)

### Notes

- Designs, materials and specifications shown are subject to change without notice due to the continuous development of our products.