

## Pressure Gauge

**P-1590 3-1/2"**

### Specifications

- EN 837-1 & ASME B40.100.
- Accuracy class:  $\pm 3/2/3\%$  of span (ASME B40.100 Grade B).

### Working Pressure

- 0/300 psi (Air/Water).

### Working Temperature

- Ambient: -40°F to 140°F (-40°C to 60°C).
- Media: 140°F (+60°C) maximum.

### Material Specifications

- Bourdon Tube  
Material: Copper Alloy  
C-type
- Pressure Connection  
Material: Copper Alloy  
1/4"NPT Lower Mount (LM)
- Movement  
Copper Alloy
- Dial  
White Aluminum with Stop Pin; Black and Red Lettering.
- Pointer  
ABS, Black Finish
- Case  
Black Polycarbonate
- Window  
Snap-in Clear Polycarbonate
- Approvals  
UL Listed (UL-393)  
FM Approved
- Temperature Error  
Additional error when temperature changes from reference temperature of 68°F(20°C)+0.4% for every 18°F(10°C) rising or falling(Percentage of Span).

### Schematic

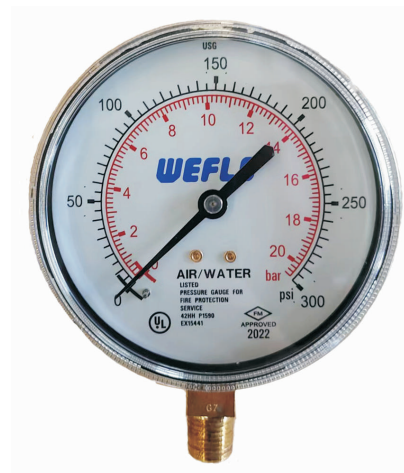

- Fire Sprinkles Systems
- Suitable for all media that will not obstruct the pressure system or attack copper alloy parts

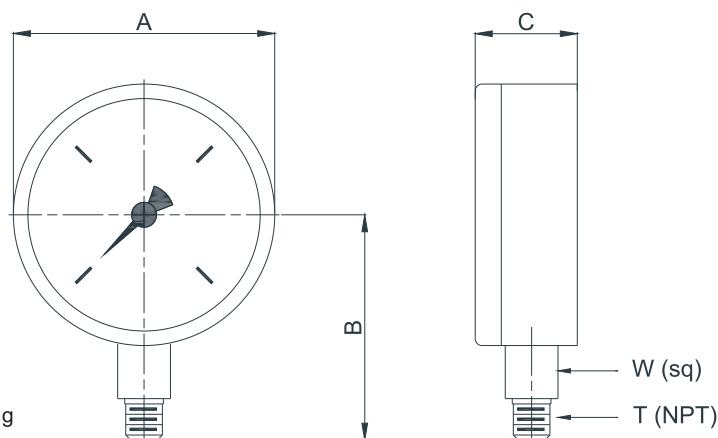

### Main Dimensions (mm/inch)

Size	A	B	C	T	W
3-1/2"	88.9 3-1/2	71/2.79	30/1.18	1/4"	14/0.55

#### Notes

- Designs, materials and specifications shown are subject to change without notice due to the continuous development of our products.