

AWWA C509 NRS Resilient Seated Gate Valve

FIG. 3226

Specification

- Meet or exceed the requirements of AWWA C509 standard.
- Full Waterway.
- 2" Square Operating Nut.
- Robust design.
- Triple O-Ring Stem Seal.
- Face to Face Dimension complies with ASME B16.10 and EN 558 Series 3.
- Flange and Drilling complies with ASTM B16.1 Class 125.
- Rated Working Pressure
300 psi for 2" to 12"
250 psi for 14" to 30"

Corrosion Protection

- Fusion Bonded Coating Interior and Exterior meet or exceed all applicable of AWWA C550 standard.

Material Specification

Part	Material	ASTM Specification
Body	Ductile Iron	A536 Grade 65-45-12
Wedge	EPDM Fully Encapsulated Ductile Iron	
Wedge Nut	Bronze	B148 C95200
Bonnet	Ductile Iron	A536 Grade 65-45-12
Stem	Stainless Steel	A276 Type 304
Gland	Ductile Iron	A536 Grade 65-45-12
Operating Nut	Ductile Iron	A536 Grade 65-45-12
Fasteners	Stainless Steel	F593 Grade 304
Body/Bonnet Gasket	Rubber	D2000 EPDM
Handwheel	Ductile Iron	A536 Grade 65-45-12

Options

- ASTM A276 Type 316 Stem.
- Fasteners: Stainless Steel A4-70.
- With Post Flange.
- Operated with Handwheel, Operating nut ,Gearbox or Actuator.

Schematic

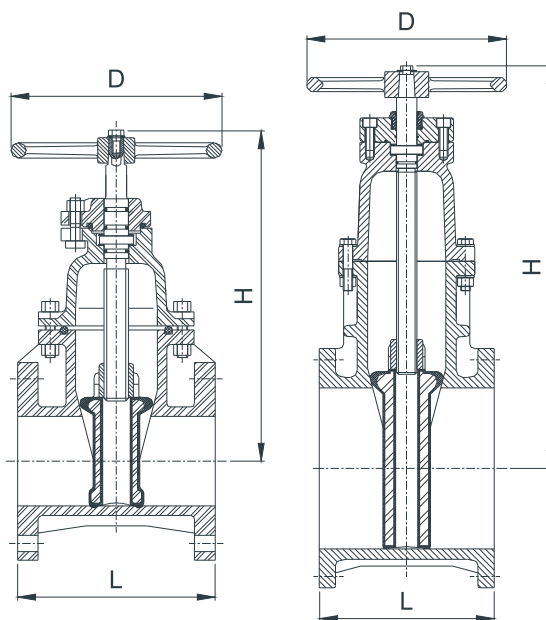
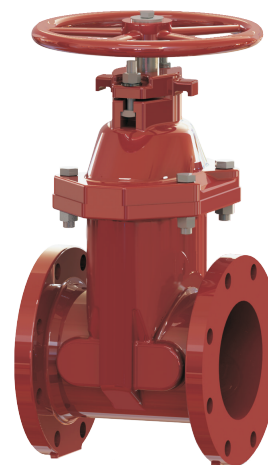

Size 2" to 12"

Size 14" and above

Main Dimensions (mm)

Size	2"	2-1/2"	3"	4"	6"	8"	10"	12"	14"	16"	18"	20"	24"
L	178	191	203	229	267	292	330	356	381	406	432	457	508
H	250	265	310	360	465	560	640	740	870	1020	1130	1200	1355
D	185	185	255	255	305	355	445	445	445	535	610	610	762

Notes

- Designs, materials and specifications shown are subject to change without notice due to the continuous development of our products.