

Y-Strainer

FIG. 7103-PN16
FIG. 7107-PN25

Specifications

- BSPT blowoff outlet on cover. Blowoff outlets are finished with plugs.
- Screens are perforated 304 stainless steel with spot welded seam.
- Recessed seat in body assures accurate screen alignment.
- Flanged and drilling complies with EN1092-2 PN16/25.
- Face to Face Dimension in accordance with DIN3202 series F1.
- Rated Working Pressure
Fig.7103: 16 bar for DN50 to DN600.
Fig.7107: 25 bar for DN50 to DN300.

Corrosion Protection

- Fusion Bonded Coating or Liquid Epoxy Painted Interior and Exterior.

Material Specification

| Part | | Material | EN Specification |
|--------|-------|-----------------|-----------------------|
| Body | | Ductile Iron | EN 1563 EN-GJS-450-10 |
| Cover | | Ductile Iron | EN 1563 EN-GJS-450-10 |
| Screen | | Stainless Steel | EN 10088 X5CrNi18-10 |
| Gasket | | Graphite | |
| Plug | 1/2" | Carbon Steel | EN 10083 C45 |
| | 1"-2" | Gray Cast Iron | EN 1561 EN-GJL-250 |

- Other material types are available upon request.

Standard Screens

| Size | Hole Dia. | Opening Ratio |
|----------------|-----------|---------------|
| DN50 to DN80 | 1.5mm | 26% |
| DN100 to DN600 | 3.0mm | 40% |

Main Dimensions (mm)

| Size | DN50 | DN65 | DN80 | DN100 | DN125 | DN150 | DN200 | DN250 | DN300 | DN350 | DN400 | DN450 | DN500 | DN600 |
|------|------|------|------|-------|--------|--------|--------|-------|-------|-------|-------|-------|-------|-------|
| L | 230 | 290 | 310 | 350 | 400 | 480 | 600 | 730 | 850 | 980 | 1100 | 1200 | 1250 | 1450 |
| H | 176 | 202 | 220 | 256 | 332 | 370 | 465 | 532 | 616 | 755 | 840 | 910 | 968 | 1160 |
| Plug | 1/2" | 1" | 1" | 1" | 1-1/4" | 1-1/2" | 1-1/2" | 2" | 2" | 2" | 2" | 2" | 2" | 2" |

Schematic

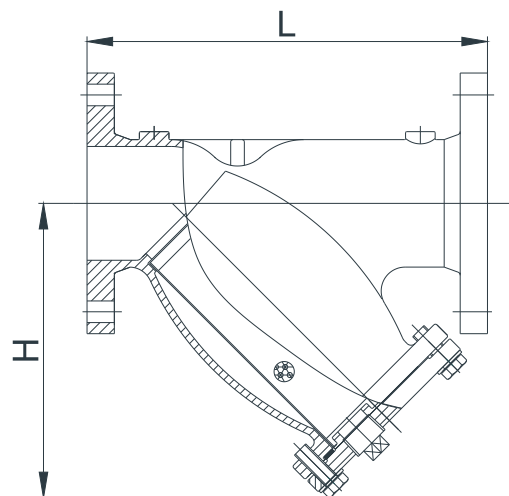

Notes

- Designs, materials and specifications shown are subject to change without notice due to the continuous development of our products.