

## Y-Strainer

**FIG. 7101**  
**FIG. 7102**

### Specifications

- NPT or BSPT blowoff outlet on cover. Blowoff outlets are finished with plugs.
- Screens are perforated 304 stainless steel with spot welded seam.
- Recessed seat in body assures accurate screen alignment.
- Flanged and drilling complies with EN1092-2 PN16/25, ANSI B 16.1 Class125.
- Rated Working Pressure  
Fig.7101: 16 bar / 200 psi for DN50 to DN600.  
Fig.7102: 25 bar / 300 psi for DN50 to DN300.
- WRAS Approved:  
Fig.7101 DN50-DN600  
DI body, EPDM Gasket for potable water.
- ANSI / NSF 61 & 372 Certificated:  
Fig: 7101: DN50-DN2000.  
For larger than DN600 product data, contact the supplier.

### Corrosion Protection

- Fusion Bonded Coating or Liquid Epoxy Painted Interior and Exterior.

### Material Specification

Part	Material	EN Specification	ASTM Specification
<b>Body</b>	Ductile Iron	EN 1563 EN-GJS-450-10	A536 Grade 65-45-12
<b>Cover</b>	Ductile Iron	EN 1563 EN-GJS-450-10	A536 Grade 65-45-12
<b>Screen</b>	Stainless Steel	EN 10088 X5CrNi18-10	A276 Type 304
<b>Gasket</b>	Graphite/EPDM		
<b>Plug</b>	1/2"	Carbon Steel	EN 10083 C45
	1"-2"	Gray CastIron	EN 1561 EN-GJL-250

- Other material types are available upon request.

### Standard Screens

Size	Hole Dia.	Opening Ratio
<b>DN50 to DN80</b>	1.5mm	26%
<b>DN100 to DN600</b>	3.0mm	40%

### Main Dimensions (mm)

Size	DN50	DN65	DN80	DN100	DN125	DN150	DN200	DN250	DN300	DN350	DN400	DN450	DN500	DN600
<b>L</b>	230	273	295	352	416	470	543	660	770	960	1079	1168	1275	1450
<b>H</b>	176	202	220	256	332	370	465	532	616	755	840	910	968	1160
<b>Plug</b>	1/2"	1"	1"	1"	1-1/4"	1-1/2"	1-1/2"	2"	2"	2"	2"	2"	2"	2"

### Schematic

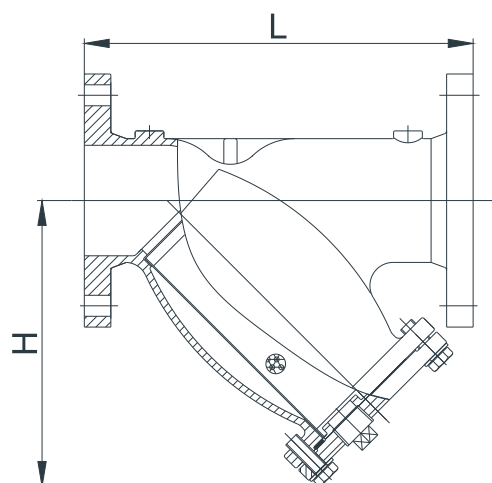

#### Notes

- Designs, materials and specifications shown are subject to change without notice due to the continuous development of our products.