

Grooved Butterfly Valve

FIG. 2902

Specification

- Meet or exceed the requirements of EN593, AS4795.1.
- Rubber Encapsulated Ductile Iron Disc.
- 2 Shafts Design.
- Mounting Flange in accordance with ISO 5211.
- Grooved Ends Dimensions meet AWWA C606 standard or other IPS pipe.
- Rated Working Pressure 16 bar /250 psi.

Corrosion Protection

- Fusion Bonded Coating Interior and Exterior.

Material Specification

Part	Material	EN Specification	ASTM Specification
Body	Ductile Iron	EN 1563 EN-GJS-450-10	A536 Grade 65-45-12
Shaft	Stainless Steel	EN 10088 X17CrNi 16-2	A276 Type 431
Disc	EPDM Encapsulated Ductile Iron		
Bushing	Brass	EN 12165 CuZn39Pb1	B124 C37700
Shaft Sealing	Rubber	EN 681 BUNA-N	D2000 NBR

Options

- 304/316 Stainless Steel Shaft.
- BUNA-N Encapsulated Disc.
- Gear Operator or Handle Operated.
- Built-in Temper Switch of Gear Operator.

Schematic

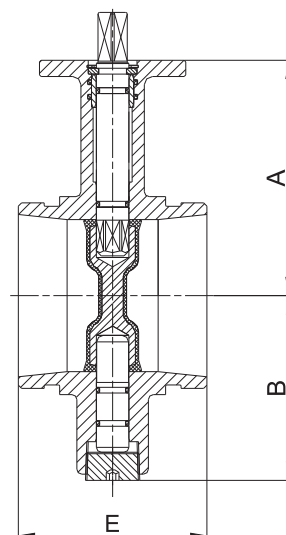
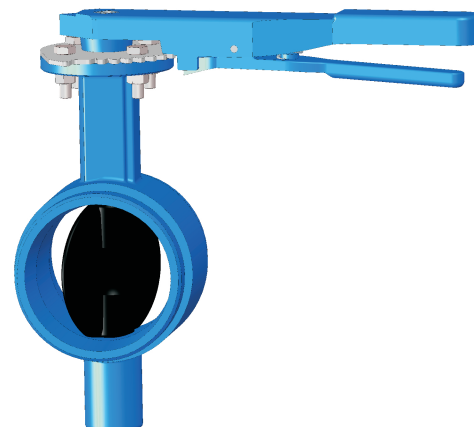

Main Dimensions (mm/inch)

Size	40/1 ½	50/2	65/2.5	80/3	100/4	125/5	150/6	200/8	250/10	300/12
A	95/3.7	100/3.9	110/4.3	115/4.5	145/5.7	145/5.7	185/7.3	200/7.9	250/9.8	275/10.8
B	72/2.8	80/3.2	85/3.4	90/3.5	110/4.3	120/4.7	145/5.7	180/7.	230/9.1	260/10.2
E	86/3.4	86/3.4	97/3.8	97/3.8	116/4.6	148/5.8	148/5.8	133/5.2	159/6.3	165/6.5
Mounting Flange	F07							F10		

Notes

- Designs, materials and specifications shown are subject to change without notice due to the continuous development of our products.