



KNIFE GATE VALVE



WAFFER/LUG TYPE KNIFE GATE VALVE WITH PNEUMATIC ACTUATOR

FEATURES

- **Model 3328**-Wafer type
Model 3528-Lug type
- Ductile Iron or Stainless Steel Body
- Uni-directional Wafer / Lug type
- Size Range: DN50 to DN300
- The cutting edge of the gate is inclined, which acts as a guide in the body and reduces the reaction force.
- NBR or EPDM Resilient Seat reduces the Operating Force necessary to close the valve.
- Full flow when fully opened, ensuring a high flow rate with low head loss.
- Connection Flanged Ends: EN1092-1/2, JIS B 2239/2220, AS 2129.
- Maximum Working Temperature:
NBR: 80°C; EPDM: 110°C
- Maximum Working Pressure:
DN50-200: 10 bar; DN250-300: 7 bar

MATERIAL

No.	Parts	Material
1	Body	EN-GJS-450-10/ Stainless Steel
2	Packing Gland	EN-GJS-450-10/ Stainless Steel
3	Nut	Carbon Steel / Type 304ss
4	Washer	Carbon Steel / Type 304ss
5	Stud	Carbon Steel / Type 304ss
6	Gate	Stainless Steel, Type 304/316
7	Support Plate	Carbon Steel
8	Safety Guards	Stainless Steel, Type 304
9	Screw	Carbon Steel / Type 304ss
10	Seat	NBR/EPDM
11	Retainer	Stainless Steel, Type 304
12	Packing	PTFE
13	O-ring	NBR
14	Bolt	Stainless Steel, Type 304
15	Nut	Stainless Steel, Type 304
16	Indicator	Stainless Steel, Type 304
17	Stem	Carbon Steel
18	Connect Seat	Carbon Steel
19	Bolt	Carbon Steel / Type 304ss
20	Spring Washer	Carbon Steel / Type 304ss
21	Dust Proof Sealing	NBR
22	Oil Bearing	Composite Material
23	Steam Gasket	NBR
24	Piston	Aluminum
25	Bolt & Washer	Carbon Steel
26	Cylinder Shell	Aluminum
27	Sealing Ring	NBR
28	Cushion Seal	NBR
29	Cylinder Cover	Aluminum

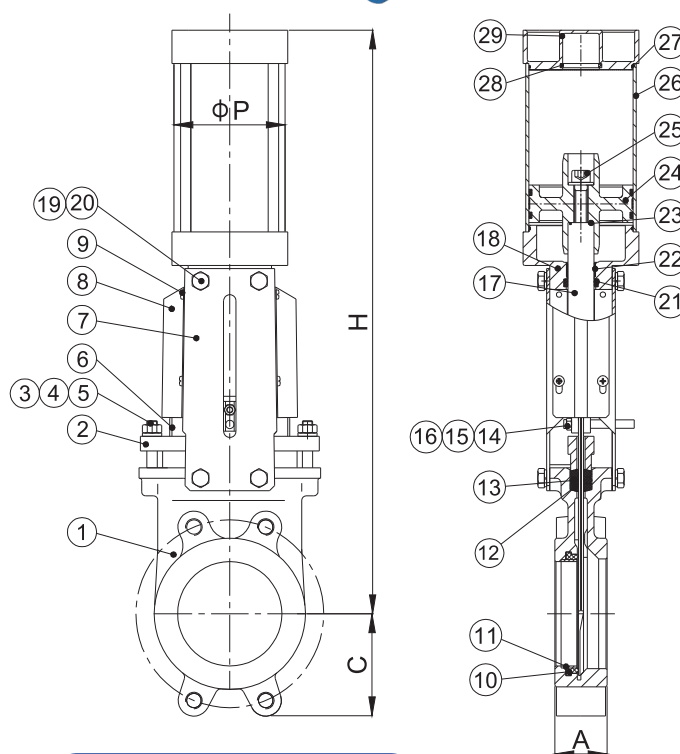

DIMENSIONS (MM)

DN	A	C	H	P
50	40	60	417	100
65	40	65	457	100
80	50	95	490	100
100	50	103	565	100
125	50	114	660	125
150	60	129	736	125
200	60	157	920	160
250	70	197	1085	200
300	80	217	1240	200

• DN300 Stainless Steel Body size A=70mm

Designs, materials and specifications shown are subject to change without notice due to the continuous development of our products.