

## Lift Check Valve

**FIG. 5318**

### Specifications

- Stainless Steel Body.
- The design is for liquid service and offers many obvious advantages when compared with conventional swing check valve.
- Spring automatically closes disc at zero flow before flow reversal occurs. This prevents surge and water hammer.
- Perfect tightness soft sealed even at low differential pressure.
- Available with flanges EN1092-2 PN10, PN16 or Pn25.
- Rated Working Pressure 25 bar, 300 psi.

### Schematic



### Material Specifications

| Part   | Material        | ASTM Specification  |
|--------|-----------------|---------------------|
| Body   | Stainless Steel | A351 Grade CF8/CF8M |
| Disc   | Stainless Steel | A351 Grade CF8/CF8M |
| Spring | Stainless Steel | A276 Grade 304      |
| Cover  | Stainless Steel | A351 Grade CF8/CF8M |

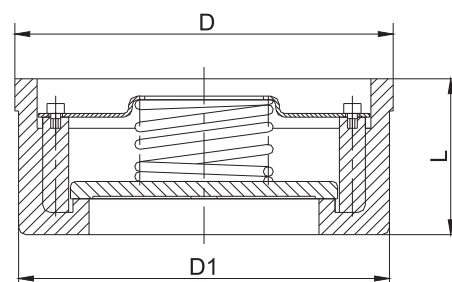

### Main Dimensions (mm)

| Size | DN15 | DN20 | DN25 | DN32 | DN40 | DN50 | DN65 | DN80 | DN100 |
|------|------|------|------|------|------|------|------|------|-------|
| L    | 16   | 19.5 | 23   | 29   | 32   | 40   | 46   | 50   | 60    |
| D    | φ53  | φ63  | φ73  | φ84  | φ94  | φ109 | φ127 | φ143 | φ163  |
| D1   | φ43  | φ53  | φ63  | φ75  | φ86  | φ94  | φ114 | φ130 | φ150  |

#### Notes

- Designs, materials and specifications shown are subject to change without notice due to the continuous development of our products.